



WAT Motor
Sanayi ve Ticaret A.Ş.

Motor type Q2MPA71M4B

Electrical Data

RATED VALUES							STARTING VALUES		BREAKDOWN	EFFICIENCY			CAPACITOR		EFFICIENCY CLASS
VOLTAGE	POWER		SPEED	CURRENT	TORQUE	cos φ	CURRENT	TORQUE	TORQUE	%			Crun	Cstart	IEC 60034-30-1
V	kW	Hz	rpm	A	Nm	4/4	I_A / I_N	M_A / M_N	Mk/ Mn	4/4	3/4	2/4	uF	uF	IE
230	0,25	50	1420	1,6	1,6	0,99	3,0	0,6	2,1	IE2-68,5	61,5	50,5	15	-	IE2

Mechanical Data

Bearing DE	6202 ZZ	Color	RAL 6011
Bearing NDE	6202 ZZ	Motor protection	No
Lubricants	No	Method of cooling	IC 411
Condensation drain hole	No	Terminal box position	Top
External earthing terminal	Yes	Material of terminal box	Aluminium
Vibration class	A	Terminal plate thread	M4
Insulation Class	F	Cable gland	1xM20
Duty type	S1	Clamping range	10-14 mm
Direction of rotation	Counter Clockwise	Mounting type	IM 2001 (B35)
Housing material	Aluminium		
Type of balancing	Half Key		

Environmental Data

Others

Ambient Temperature	-20 / + 40 °C	Type of protection	IP56
Altitude above sea level	1000 m	Moment of Inertia (kg.mm ²)	0,0011
		Standard	IEC 60034-1

Dimensions

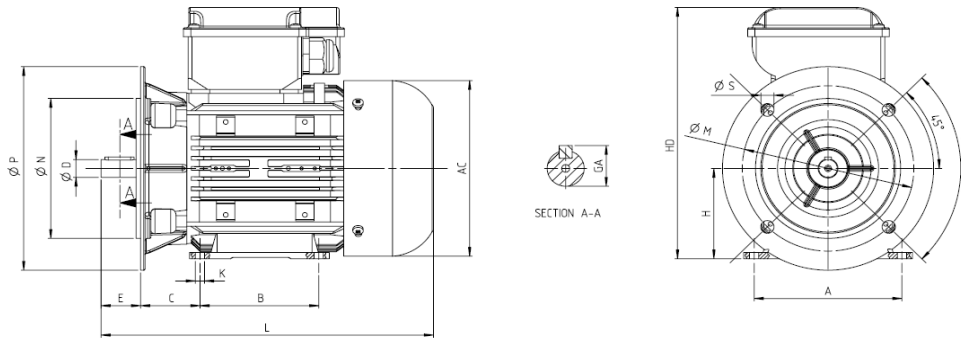

Main Dimensions		Foot Mounted Motors					Shaft					Flange Mounted Motors			
AC	L	B	A	H	HD	K	C	D	E	GA	F	P	N	M	R
138	252	90	112	71	197,5	7	45	14	30	16	5	160	110	130	10