



WAT Motor
Sanayi ve Ticaret A.Ş.



Smoke Extraction Motor F400 2 Hour EN 12101-3

Motor Type: S3HG90L2D40-KG

Electrical Data

RATED VALUES						STARTING VALUES				BREAKDOWN	EFFICIENCY			EFFICIENCY CLASS	
VOLTAGE V	POWER kW Hz		SPEED rpm	CURRENT A	TORQUE Nm	Cos φ	CURRENT I_A / I_N			TORQUE M_A / M_N		TORQUE Nm			IEC 60034-30-1
	4/4	Y	D	Y	D	Mk/ Mn Nm	4/4	3/4	2/4	IE					
230/400	2,2	50	2928	7,4/4,3	7,2	0,86	10,00		3,20		4,30	IE3-85,9	85	83	IE3
265/460	2,2	60	3568	6,8/3,9	5,9	0,85	9,50		3,04		4,09	IE3-86,5	85,6	83,6	IE3

Mechanical Data

Bearing DE	6305 ZZ C4 DUPONT260C ORS	Color	Optional
Bearing NDE	6205 ZZ C4 DUPONT260C ORS	Motor protection	Optional
Lubricants	Dupont GPL 226 Krytox (260 C°)	Method of cooling	IC 418
Condensation drain hole	No	Terminal box position	Top
External earthing terminal	Yes	Material of terminal box	Cast Iron
Vibration class	A	Cable gland	M25x1.5
Insulation class	H	Clamping range	13-18
Duty type	S1	Mounting type	IM 1001 (B3)
Direction of rotation	Clockwise		
Housing material	Cast Iron		
Type of balancing	Half Key		

Environmental Data

Others

Ambient temperature	-20 / + 40 °C	Type of protection	IP56
Altitude above sea level	1000 m	Sound pressure level 50/60Hz	dBA 62
		Moment of inertia (kgm ²)	0,00283
		Standard	IEC 60034-1
		Weight (kg)	29,8
		Resistance to fire	400 C° 2 Hour F400 EN 12101-3

Dimensions

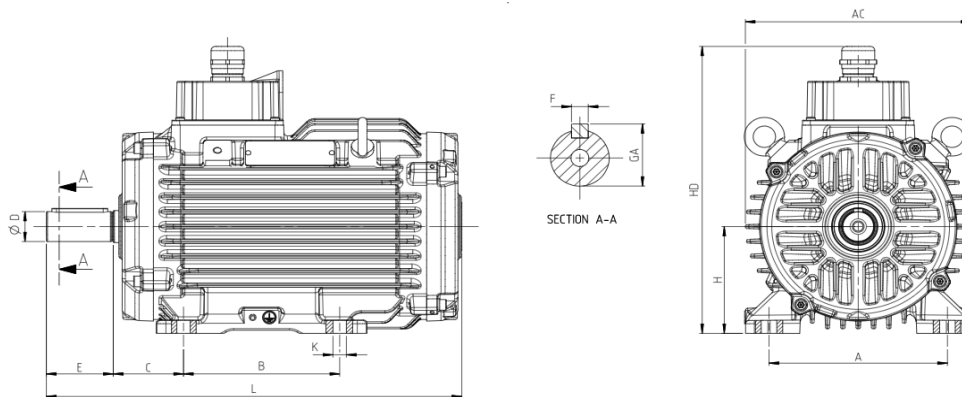

Main Dimensions		Foot Mounted Motors						Shaft				Flange Mounted Motors			
AC	L	B	A	H	HD	K	C	D	E	GA	F	P	N	M	S
185	325	125	140	90	242	10	56	24	50	27	8				