



WAT Motor
Sanayi ve Ticaret A.Ş.



Smoke Extraction Motor F400 2 Hour EN 12101-3

Motor Type: S4HG315M2B40-KG

Electrical Data

RATED VALUES							STARTING VALUES				BREAKDOWN	EFFICIENCY			EFFICIENCY CLASS
VOLTAGE	POWER		SPEED	CURRENT	TORQUE	Cos φ	CURRENT		TORQUE		TORQUE				IEC 60034-30-1
V	kW	Hz	rpm	A	Nm	4/4	I _A / I _N	D	M _A / M _N	Y	Mk/ Mn Nm	4/4	3/4	2/4	IE
400/690	132	50	2986	228,2/131,9	422,1	0,88		9		3,8	10,4	IE4-96,2	96,1	92,5	IE4

Mechanical Data

Bearing DE	6316 ACIK C4 YOK ORS	Color	Optional
Bearing NDE	6316 ACIK C4 YOK ORS	Motor protection	Optional
Lubricants	Dupont GPL 226 Krytox (260 C°)	Method of cooling	IC 418
Condensation drain hole	No	Terminal box position	Top
External earthing terminal	Yes	Material of terminal box	Cast Iron
Vibration class	A	Cable gland	M50x1.5
Insulation class	H	Clamping range	34-44
Duty type	S1	Mounting type	IM 1001 (B3)
Direction of rotation	Clockwise		
Housing material	Cast Iron		
Type of balancing	Half Key		

Enviromental Data

Others

Ambient temperature	-20 / + 40 °C	Type of protection	IP56
Altitude above sea level	1000 m	Sound pressure level 50/60Hz	dBA 87
		Moment of inertia (kgm ²)	1,84
		Standard	IEC 60034-1
		Weight (kg)	952,0
		Resistance to fire	400 C° 2 Hour F400 EN 12101-3

Dimensions

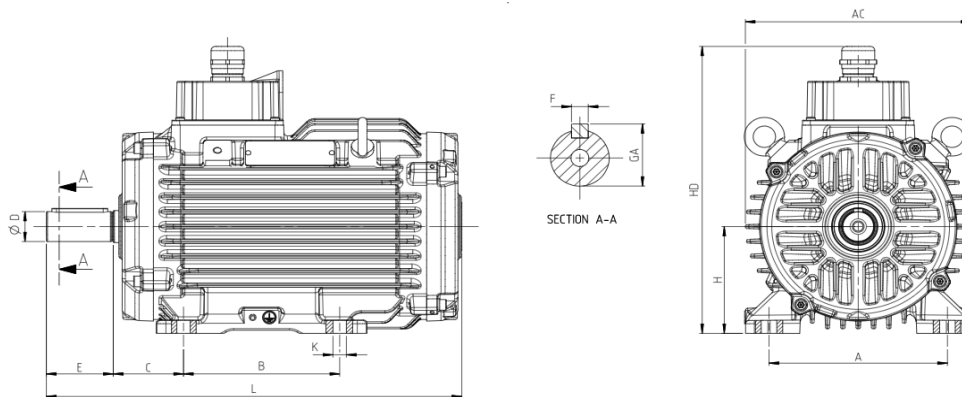

Main Dimensions		Foot Mounted Motors						Shaft				Flange Mounted Motors			
AC	L	B	A	H	HD	K	C	D	E	GA	F	P	N	M	S
645	977,5	406	508	315	823	28	216	65	140	69	18				